

Mind xPlay

First-Time Setup Tutorial

Video Tutorial

Before using **Mind xPlay** for the first time, please watch the video tutorial and follow the instructions carefully. Otherwise, Mind xPlay may not function properly.

Mind xPlay First-Time Setup – Video Tutorial

<https://dl.khadas.com/products/mind-xplay/videos/mind-xplay-first-time-setup-tutorial-en.mp4>

Text Tutorial

Alternatively, you can read and carefully follow the instructions below to complete the setup.

When using Mind xPlay with a Mind PC for the first time, please complete the following steps in order:

1. Update your Mind PC to the latest software version (Mind App, BIOS, and EC).
2. Connect Mind xPlay to your Mind PC.
3. Connect Mind xPlay to power and turn it on.
4. Configure the Device Mode When Unplugged in the Mind App.

Detailed Instructions:

1. Before using Mind xPlay, update your Mind PC by following these steps:

a) Connect your Mind PC to power using the original power adapter and USB-C cable.

Note: Do NOT connect Mind xPlay until you reach Step 2.

b) Connect your Mind PC to a display using an HDMI cable.

c) Press the power button to turn on your Mind PC.

d) Open the **Mind App** and follow the on-screen prompts to update it. Alternatively, right-click the Mind App icon in the Windows system tray and select **Check for updates**.

Optional: You may also download **Mind App v1.60 or later** from: <https://dl.khadas.com/products/mind-series/app/>

e) In the Mind App, go to **Mind > Device Update > BIOS Update**, then click Check for updates to upgrade to the latest BIOS version. The system will restart automatically after the update.

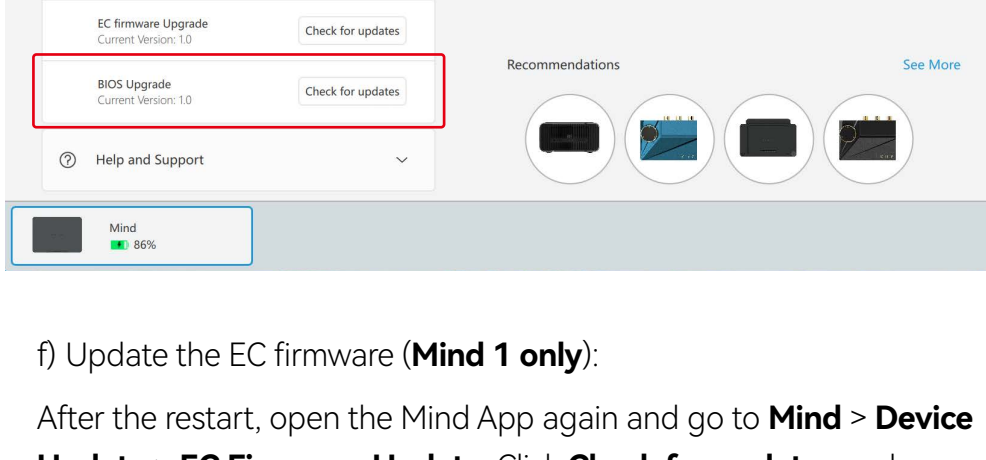

f) Update the EC firmware (**Mind 1 only**):

After the restart, open the Mind App again and go to **Mind > Device Update > EC Firmware Update**. Click **Check for updates** and complete the update. The system will restart automatically.

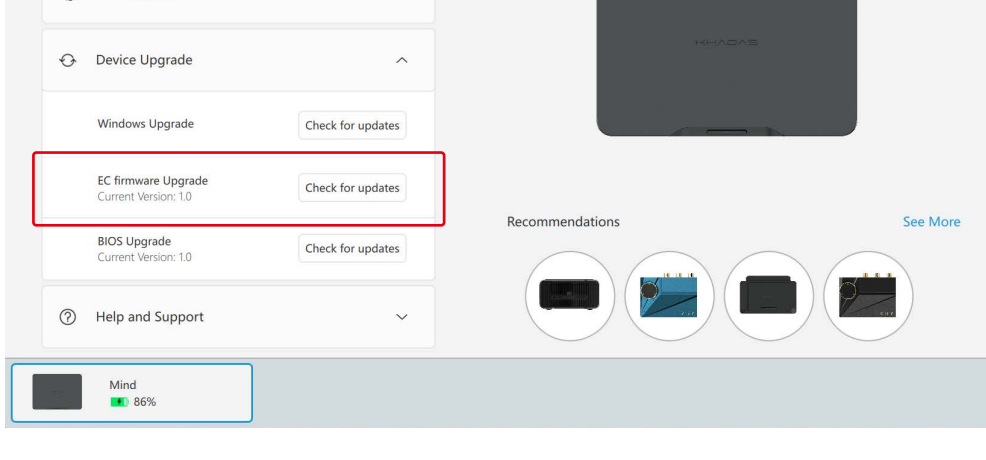

2. Connect Mind xPlay to Mind PC

Choose the appropriate setup based on your package:

a) Display + Keyboard Bundle

i. Align the keyboard connector with the port on the bottom of Mind xPlay and gently attach it. The keyboard will magnetically snap into place.



ii. Align the Mind Link interface on the bottom of the Mind PC with the Mind Link interface on the back of Mind xPlay, and then gently attach. It will snap into place securely.



iii. Open the stand and place Mind xPlay on a flat surface with the keyboard unfolded.



b) Display-Only Bundle

i. Align the Mind Link interface on the bottom of the Mind PC with the Mind Link interface on the back of Mind xPlay, and then gently attach. It will snap into place securely.

ii. Open the stand and place Mind xPlay on a flat surface.

3. Power On Mind xPlay

a) For first-time use, connect the official Mind power adapter to any USB-C port on Mind xPlay to activate the device.



b) Press and hold the power button of Mind xPlay for 1.5 seconds. Mind xPlay will power on and automatically connect to your Mind PC.



4. Configure Device Mode When Unplugged

a) For a smooth cross-scenario experience, configure **Device Mode When Unplugged** in the Mind App based on your needs:

Sleep

Best for short transitions. The device enters sleep when unplugged and wakes automatically when power is restored.

Hibernate

Suitable for longer transitions. The device enters hibernation when unplugged. Press the power button to resume after reconnecting power.

Use Battery

Ideal for demos or meetings. The system continues running on the built-in battery with reduced performance, and the display remains on. Battery life is rather limited under this mode.

b. After configuration, Mind PC will enter the selected state when unplugged from power.

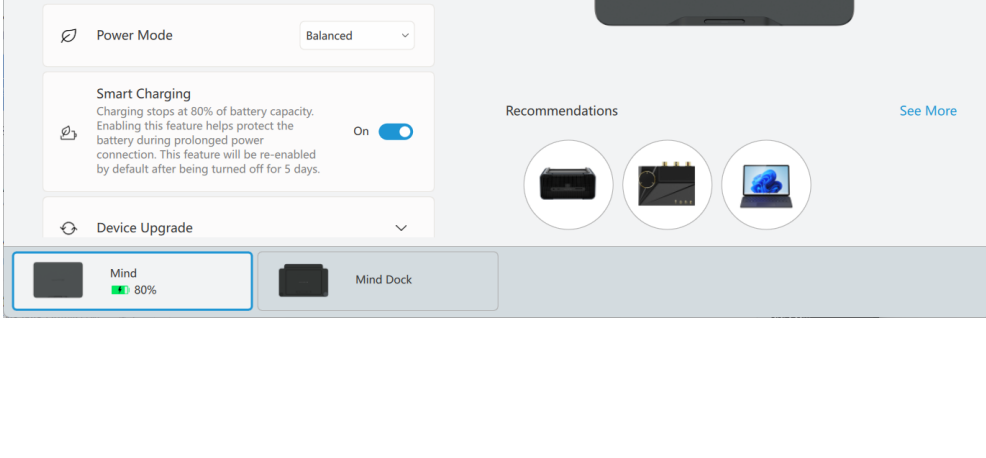

Mind xPlay – Indicator Light

Color	White ○	Yellow ●	Red ●	Off ●
-------	---------	----------	-------	-------

Breathing	Powered on, charging	Powered off, charging	Powered on, charging, low battery	/
------------------	----------------------	-----------------------	-----------------------------------	---

Solid On	Unplugged: powered on Plugged: powered on, fully charged	Powered off, fully charged	Unplugged: powered on, low battery	Unplugged: sleep or powered off
-----------------	---	----------------------------	------------------------------------	---------------------------------

Flashing	Power-on action	Power-off action	Battery error	/
-----------------	-----------------	------------------	---------------	---